

型号/TYPE	A	B	C	D	E	F	G	H	O-ring
DXYYS08-G1/4	101	90	30	40	64	40	32	34	15X2.65
DXYYS08-G3/8	101	90	30	40	64	40	32	34	15X2.65

## 技术参数/TECHNICAL DATA:

应用材料/MATERIAL EMPLOYED

阀体/BODY: 钢/STEEL

阀芯/VALVES: 钢/STEEL

密封/SEALS: 丁腈胶/NBR

温度/TEMPERATURES

理想工作温度: +40°C~+70°C

Ideal operating range between +40°C and +70°C

最低/最高环境温度: -20°C~+60°C

Min/Max environment temps -20°C~and

最高工作温度: 90°C/Max operating temperature 90°C

## 符号/SYMBOL:

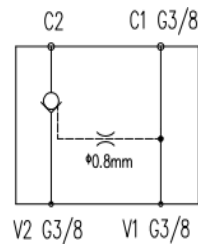

## 外形尺寸/OVER

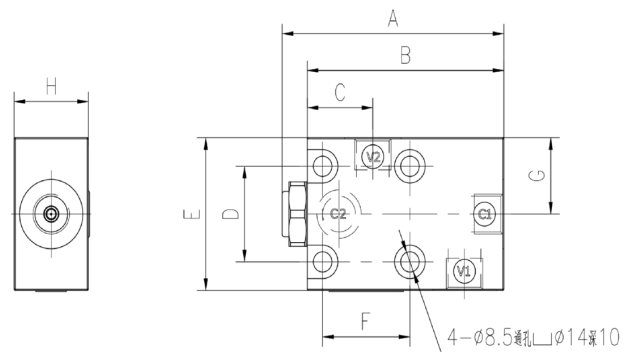

## 型号说明/MODEL CODE:

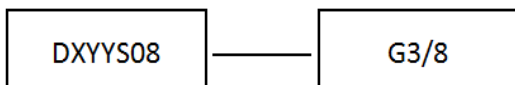

①

②

①单向液压锁系列代号/single pilot check valve series code :DXYYS08型/DXYYS08 type

②阀体连接螺纹形式/connect thread dimension:BBSP

型号/TYPE	最大压力 (bar)		最大流量 (L/min)	先导比 (pilot ratio)	开启压力 (cracking pressure) (bar)
	钢/steel	铝/aluminum			
DXYYS08-G1/4	300	200	20	3.2: 1	3.5
DXYYS08-G3/8			30		

## 流量曲线图/FLOW DIAGRAM:

